

Multiplex 100+Offices School
50+Industrial Units 500+Homes
500+Shops Mall Restaurants
School 200+Industrial Gala
Restaurants 500+Homes 100+Bed Hospital
50+Industrial Units 100+Offices
A
WORLD WITHIN
100+Offices Multiplex
100+Bed Hospital 500+Shops
50+Industrial Units 500+Shops
500+Homes Restaurants 200+Industrial Gala
Mall 500+Homes 100+Bed Hospital
500+Shops 50+Industrial Units 100+Offices



CAPITAL
SQUARE

100+
SHOPS

""BWo XwH\$mZ áhUOo
df©^a Y\$Xm VoOrV..."

Capital City is a business paradise in making. Situated at the heart of one of the most industrialized areas of the city, a commercial venture here is bound to fetch maximum returns. Besides being backed by 500+ apartments could easily be translated into consistent inflow of customers. And considering the pace at which the PCMC region is growing, every business here is bound to flourish.

Multiplex | Restaurant | Mall | Showrooms | Banks | Hospital





Legends

- | | |
|-------------------------------------|--|
| A Capital Square | G Capital Industrial Complex I |
| B Capital City | H Capital Industrial Complex II |
| C Capital Industrial Park I | I Nighoje Business Center |
| D Nighoje Logistics | J Capital Plaza |
| E Capital Industrial Park II | K Capital Mall |
| F Nighoje Logistics | L Capital International School |



CAPITAL CITY

a world within

Residential | Commercial | Industrial

Make a move.

Be blessed by a rewarding future.

Belong to a place on earth that is destined to grow every moment. Spread across whopping 30 acre on the fastest developing growth corridor of Pune, this is a paradise of good fortune & golden opportunities! Here, the residential development comprising 1 & 2 BHK, studio apartments is surrounded by educational, commercial, industrial, entertainment & leisure hubs. An office, a shop, an industrial gala or unit, a grand showroom, a well-equipped healthcare facility or a home here where every treasured happiness is within easy reach is for the forward thinking people who see beyond future and make the most of the present. Welcome to the Growth Hub.

Near Talawade IT Park,
Opp. Mahindra & Mahindra, Pune.



CAPITAL SQUARE

STAR
RESTAURANTS

Spread across 1 acre Plus
9 storeyed commercial complex
112 Shops of 300 to 1500 sq. ft.
160 Apartment of 300 to 500 sq. ft.
Restaurant of 5000 to 8000 sq. ft.
Office of 500 to 8000 sq. ft.
ATM & Bank

Key Features & Amenities

Elevators | Escalator | Wi-fi connectivity
Multilevel Parking | Fire Systems
Generator Backup for common Area





LOWER GROUND FLOOR PLAN





FIRST FLOOR PLAN





SECOND FLOOR PLAN



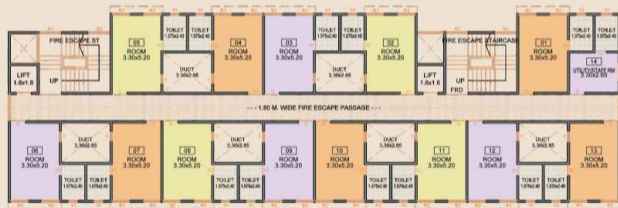
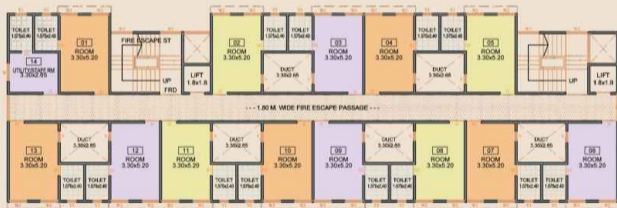

3rd, 4th, 5th, 6th & 7th FLOOR PLAN





The Rising Location

PCMC has long been the preferred territory of the new-age, progressive families. But this location where Capital City is being constructed, is a refreshingly pleasant surprise. It is bang opposite to Mahindra & Mahindra Plant of Nighoje, simply a few seconds from Chakan-Talegaon Road. The Chakan MIDC is on 5 minutes drive and fast-developing Talawade IT Park is at hardly any distance of just 2 kilometers. It means, Capital City is strategically placed near manufacturing & IT hubs of PCMC. Besides easy connectivity to upmarket suburbs of Nigdi, Akurdi, Bhosari, Chinchwad etc. elevate the standards of living here. So be it professional, career opportunities or an empowered lifestyle, the new rising location of PCMC upholds a wonderful living experience for sure.

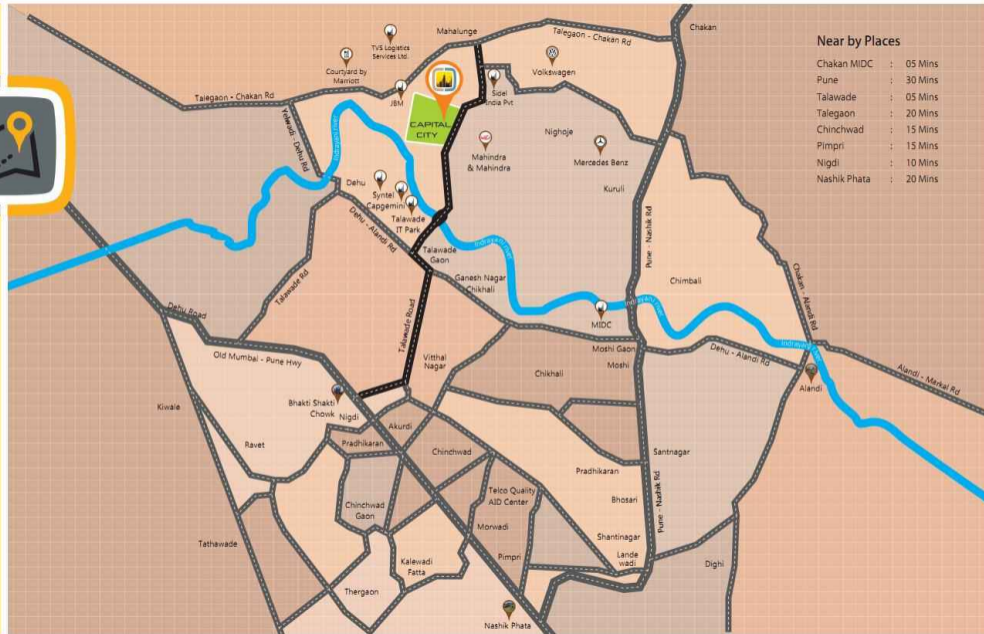



Office : CTS 4441, Hotel Kundan Place, Mumbai - Pune Road, Akurdi, Pune - 35 | Ph.: 020 2724 2424

Site Address : Near Talawade IT Park, Opp. Mahindra & Mahindra, Nighoje, Pune

Ph.: 70660 40544 | 70300 03344 | Email : sales@capitalcity.co.in | website : www.capitalcity.co.in

